

	ANS-1 (HWY 417 EB)	ANS-2 (HWY 417 WB ON-RAMP)
ADVANCE NOTIFICATION - TWO WEEKS PRIOR TO SCHEDULED RAMP CLOSURE	ACCESS TO BRONSON TO BE CLOSED DD MMM YY - DD MMM YY	ACCESS TO 417 WEST TO BE CLOSED AT BRONSON DD MMM YY - DD MMM YY
	ACCÈS À BRONSON SERA FERMÉ JJ MMM AA - JJ MMM AA	ACCÈS À LA 417 OUEST SERA FERMÉ À BRONSON JJ MMM AA - JJ MMM AA

	AWS-1	AWS-2
ADVANCE WARNING - DURING RAMP CLOSURE	ACCESS TO BRONSON CLOSED FOLLOW D-1	ACCESS TO 417 WEST CLOSED AT BRONSON FOLLOW D-2
	ACCÈS À BRONSON FERMÉ SUIVRE D-1	ACCÈS À LA 417 OUEST FERMÉ À BRONSON SUIVRE D-2

	ARS-1
ADVANCE ROUTE SIGNING - DURING RAMP CLOSURE	BRONSON VIA CARLING
	ARS-2
	BRONSON VIA KENT

NOTES:

1. PLACEMENT OF TEMPORARY CONDITIONS SIGNAGE SHALL NOT OBSTRUCT MOTORISTS' VIEW OF EXISTING SIGNAGE.
2. MINIMUM SEPARATION BETWEEN ENGLISH AND FRENCH SIGNAGE SHALL BE 50m ON CITY STREETS AND 150m ON HIGHWAY 417.
3. ADVANCE NOTIFICATION SIGNS (ANS) TO BE INSTALLED 2 WEEKS PRIOR TO THE RAMP CLOSURE.
4. ADVANCE WARNING SIGNS (AWS) AND DETOUR TRAILBLAZER SIGNS (DTS) SHALL BE INSTALLED AND REMAIN IN PLACE DURING THE RAMP CLOSURE. TABS SHALL BE USED TO CHANGE SIGNS FROM ADVANCE NOTIFICATION TO ADVANCE WARNING.
5. RAMP CLOSURES SHALL BE AS SPECIFIED ELSEWHERE IN THE CONTRACT.
6. CONTRACTOR SHALL CLOSE LANES ON CITY STREETS THAT LEAD TO CLOSED RAMPS AS DETAILED ELSEWHERE.
7. OFF-RAMP CLOSURES EXCEEDING ONE WEEKEND IN DURATION REQUIRE BILINGUAL TEMPORARY CLOSED TABS AS DETAILED ELSEWHERE. TO BE PLACED ACROSS OVERHEAD GUIDE SIGNS.
8. LYON N-W RAMP CLOSED FOR DURATION OF CONSTRUCTION, SIGNAGE FOR CLOSURE DETAILED ELSEWHERE.
9. SIGNAGE MAY REQUIRE COORDINATION WITH ADJACENT CONSTRUCTION ZONES. CONTRACTOR TO COORDINATE WITH CONTRACT ADMINISTRATOR.

LEGEND

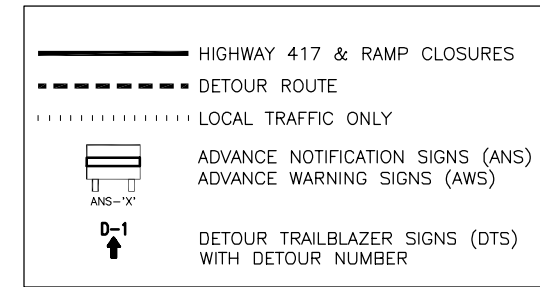

METRIC

PLATE No
CONT No 2020-4075
WP No 4173-15-00

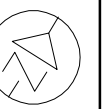

HWY 417 RAMP CLOSURE
DETOUR ROUTING
BRONSON INTERCHANGE

SHEET
34

